

Ceiling Mount CM10

PRODUCT NUMBER

1960

DIMENSIONS

4" H x 10" W x 2" D

INSTALLATION METHOD

Bolted to ceiling surface with appropriate fasteners.

SYSTEM USES

Available for all 10" wide signs.

CONSTRUCTION

1/8" thick extruded aluminum angle bracket

FINISH

Standard Cabinet Color: Duranodic Bronze
Custom colors available upon request

Trans-Tech

4999 Pittsburgh Ave.
Erie, PA 16509
Phone: (888) 811-7010
Fax: (814) 836-8401

Email: sales@transportation-tech.com

Website: www.transportation-tech.com

Proudly Made in the USA



Product View

NOTE: Sign image may not exactly represent the finished product. For illustration purposes only.

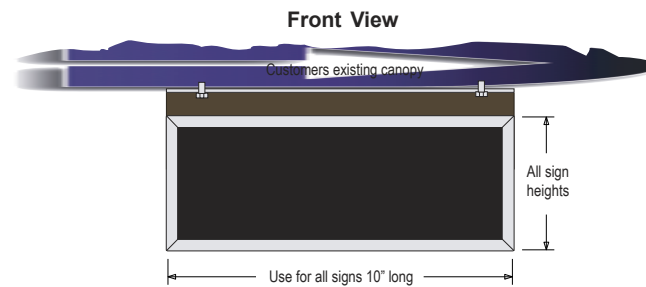

Side View

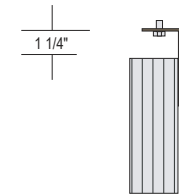

Back View

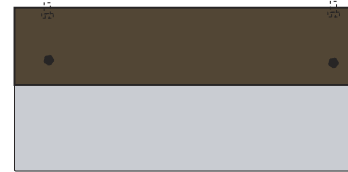

Ceiling Mount-Typical Detail

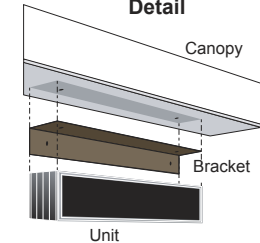

Ceiling Mount

- Remove the back panel.
- Mount the ceiling bracket to the desired surface (*Fasteners Not Supplied*).
- Mount the back panel to the ceiling bracket (*Fasteners Not Supplied*).



Note: Make appropriate wiring connections per local codes.

Note: Do not over tighten or distort back panel. Hang the cabinet on the top edge of the back panel

- Hinge cabinet back and replace the screws that were removed in step one on the reverse side.

